

OM7604C7

Low Power 32.768kHz SM Oscillator with Metal Lid

- Ultra low power consumption
- Ultra-miniature 32.768kHz oscillator
- High shock and vibration resistance
- Industrial and extended temperature ranges
- AEC-Q200 qualification available



CONFIGURABLE OPTIONS

Parameter	Option Code
Calibration tolerance	
±20ppm max	
Operating temperature range	
Any	
-40 to +85°C	
-40 to +125°C	E
Qualification	
Any	
Commercial	
AEC-Q200 (Automotive)	A

SPECIFICATIONS

Frequency	32.768kHz
Dimensions	3.2 x 1.5 x 0.7mm
Turnover temperature (T ₀)	+25°C ±5°C
Frequency / temp coefficient	-0.035ppm/°C ² ±10%
Storage temperature range	-55 to +125°C
Supply voltage (V _{DD})	Operable from 1.2 ~ 5.5V
Supply current (backup mode)	0.3µA typ, 0.5µA max (V _{DD} 3.0V, output disabled)
Logic levels	'0' level = +0.4V max '1' level = V _{DD} -0.4V min
Waveform symmetry	40:60 max @ 50%V _{DD}
Driving ability	10pF CMOS
Voltage coefficient	±1.5ppm/V max
Rise / fall time	70ns typ, 100ns max
Start up time	500ms max @ 25°C
Enable / disable function	Control via pad 3
Ageing	±3ppm max first year @ 25°C
Shock resistance	±5ppm, 5,000g, 0.3ms ½-sine
Vibration resistance	±5ppm, 20g rms 10.0 ~ 2,000Hz
Soldering condition:	Reflow, 260°C, 20 sec max

PACKAGE DRAWING

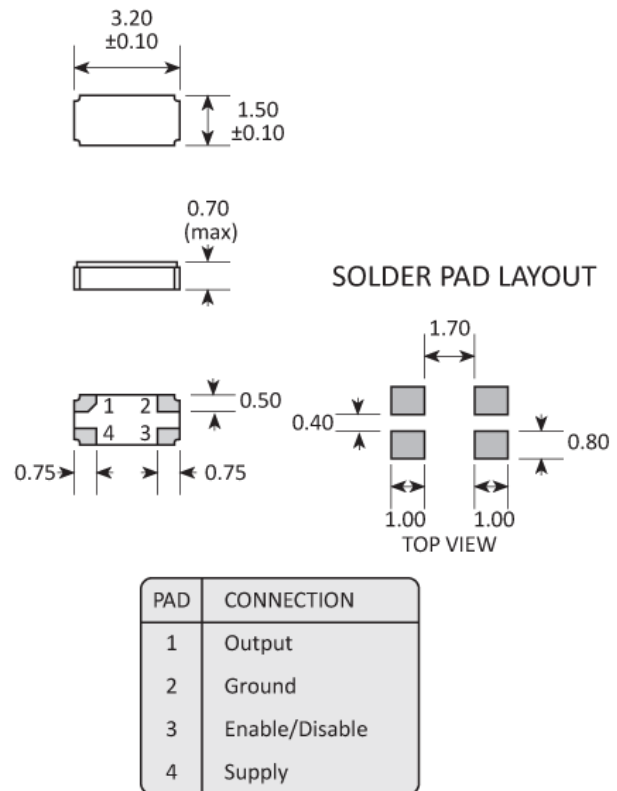

Dimensions in mm

ORDERING INFORMATION

To request a quotation for the OM7604C7 please use the configurable options form to choose the options you require and then submit your configured product to our team. Our expert advisers are always happy to help with your requirements and can be contacted on +44 1460 256 100 or at sales@golledge.com.

Following product selection you will be issued with a seven character Golledge part number. Your Golledge part number is the internationally accepted Golledge manufacturing part number (MPN) that should be used for all project documentation, including bills of materials (BoMs) and purchase orders.

If you have any queries regarding any of our documentation our dedicated sales team will be happy to help.

ENABLE / DISABLE FUNCTION

Input (pad 3)	Output (pad 1)
'1' level	Enabled
'0' level	Disabled

Note: Pad 3 should not be allowed to float

TAPE & REEL SPECIFICATION

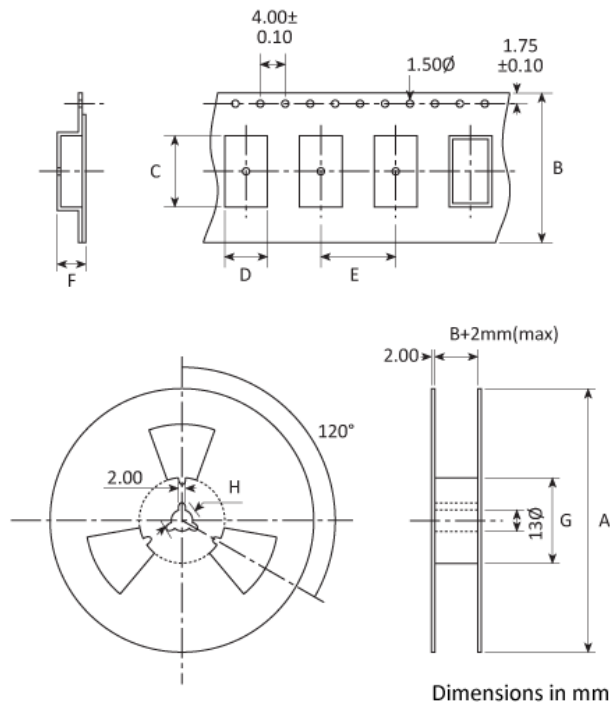

A:178 / B:12 / C:3.5 / D:1.8 / E:4 / F:0.9 / G:61.5 / H:13

CONSTRUCTION

Ceramic base and metal lid

HANDLING & STORAGE



Human Body Model (HBM) 1A (250V to < 500V)



Moisture Sensitivity Level (MSL): 1