

# HC49J

## SM Crystal Formed Leads

- Fundamental mode available up to 40.0MHz
- Low cost for volume applications
- Express manufacturing service
- Custom frequencies easily produced
- Tight specifications available

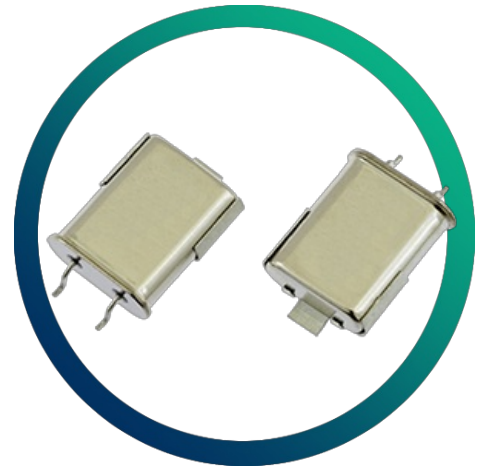

## CONFIGURABLE OPTIONS

Parameter	Option Code
-----------	-------------

## PACKAGE DRAWING

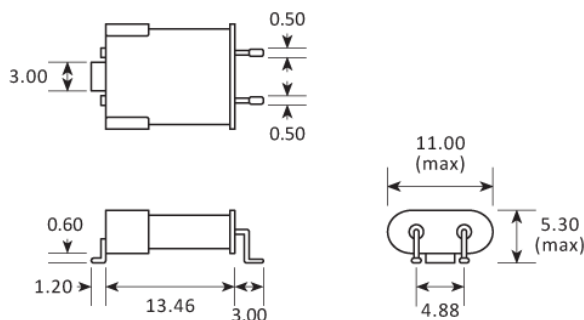

### SOLDER PAD LAYOUT

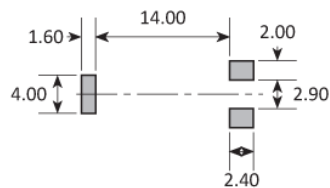

Dimensions in mm

## ORDERING INFORMATION

To request a quotation for the HC49J please use the configurable options form to choose the options you require and then submit your configured product to our team. Our expert advisers are always happy to help with your requirements and can be contacted on +44 1460 256 100 or at [sales@golledge.com](mailto:sales@golledge.com).

Following product selection you will be issued with a seven character Golledge part number. Your Golledge part number is the internationally accepted Golledge manufacturing part number (MPN) that should be used for all project documentation, including bills of materials (BoMs) and purchase orders.

If you have any queries regarding any of our documentation our dedicated sales team will be happy to help.

## TAPE & REEL SPECIFICATION

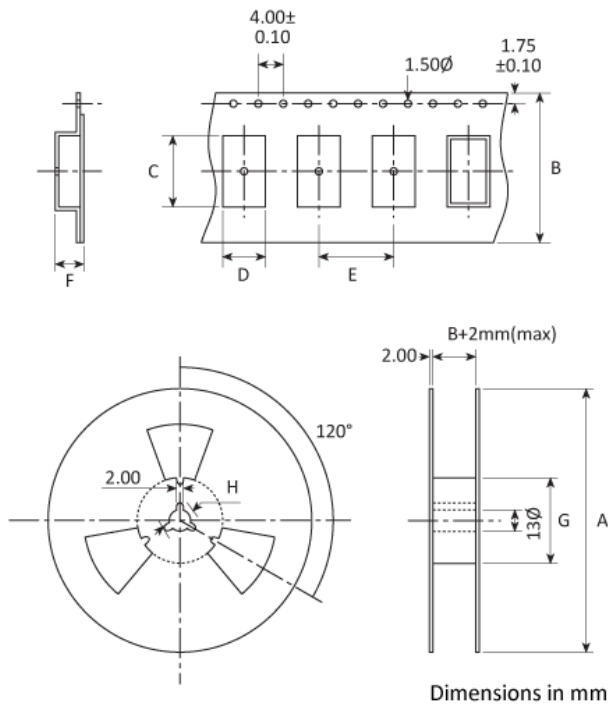

A:330 B:24 C:18.5 D:11.4 E:16 F:5.7 G:100 H:21

## CONSTRUCTION

Resistance weld

## HANDLING & STORAGE



Human Body Model (HBM) 1A (250V to < 500V)



Moisture Sensitivity Level (MSL): 1

## COMPLIANCE



Lead-free (< 0.1% by weight)



RoHS compliant with no exemptions.