

# GTXO-C74T

## 3.3V VCTCXO CMOS Low Phase Noise

- Low phase noise
- CMOS output
- Miniature SM package
- Sealed crystal design

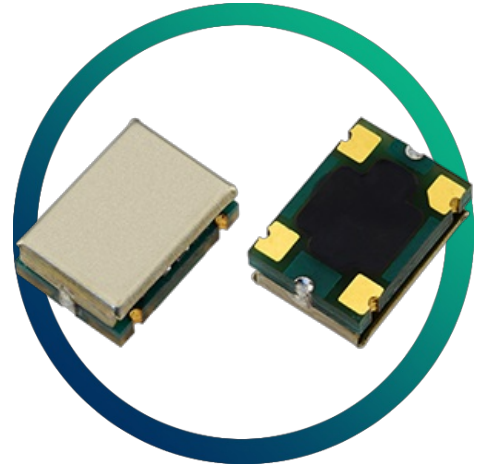

### CONFIGURABLE OPTIONS

Parameter	Option Code
Frequency	
Frequency stability	
Any	
±2.5ppm	J
±2.0ppm	H
±1.5ppm	G
Temperature range	
Any	
-20 to +70°C	N
-30 to +75°C	S
-40 to +85°C	I

## SPECIFICATIONS

Frequency range	30.0 ~ 61.44MHz
Dimensions	7.0 x 5.0 x 2.5mm
Storage temperature range	-40 to +85°C
Supply voltage stability	±1.0ppm, $V_{DD}$ ±5%
Driving ability	15pF CMOS
Logic levels	'0' level = 10% $V_{DD}$ max '1' level = 90% $V_{DD}$ min
Waveform symmetry	45:55 @ 50% $V_{DD}$
Ageing	±1.0ppm max first year
Supply voltage ( $V_{DD}$ )	+3.3V ±5%
Supply current	20.0mA max
Start up time	3ms max
Frequency adjustment	None
Phase noise (typ @ 61.44MHz)	-84dBc/Hz @ 10Hz -115dBc/Hz @ 100Hz -141dBc/Hz @ 1kHz -154dBc/Hz @ 10kHz
Preset frequency @ 25°C	±2.0ppm max

## PACKAGE DRAWING

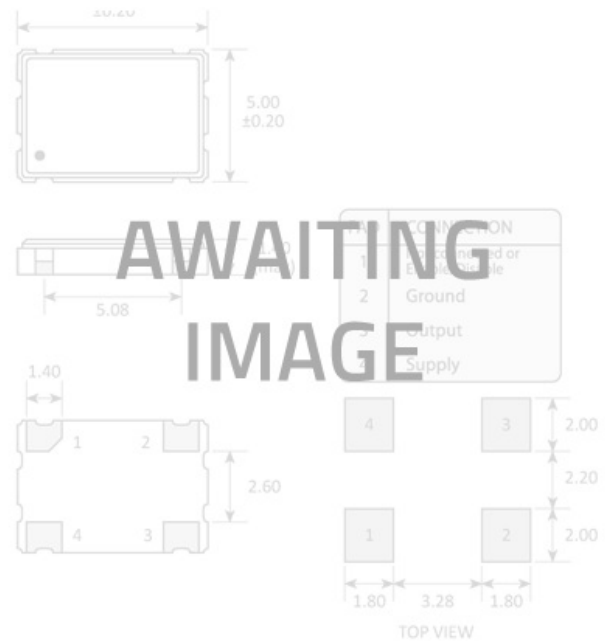

## ORDERING INFORMATION

To request a quotation for the GTXO-C74T please use the configurable options form to choose the options you require and then submit your configured product to our team. Our expert advisers are always happy to help with your requirements and can be contacted on +44 1460 256 100 or at [sales@golledge.com](mailto:sales@golledge.com).

Following product selection you will be issued with a seven character Golledge part number. Your Golledge part number is the internationally accepted Golledge manufacturing part number (MPN) that should be used for all project documentation, including bills of materials (BoMs) and purchase orders.

If you have any queries regarding any of our documentation our dedicated sales team will be happy to help.

## MARKING

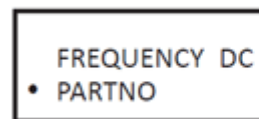

- Pin 1  
Marking type: Laser

DC = Date Code in YM, eg. "GF" = Jun 2017

	A	B	C	D	E	F	G	H	J	K	L	M
Y	1	2	3	4	5	6	7	8	9	0		
M	Jan	Feb	Mar	Apr	May	Jun	Jul	Aug	Sep	Oct	Nov	Dec

## SOLDERING PROFILE

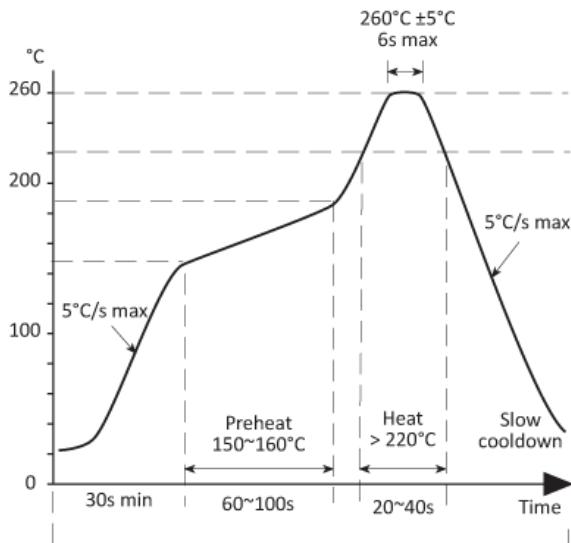

## TAPE & REEL SPECIFICATION

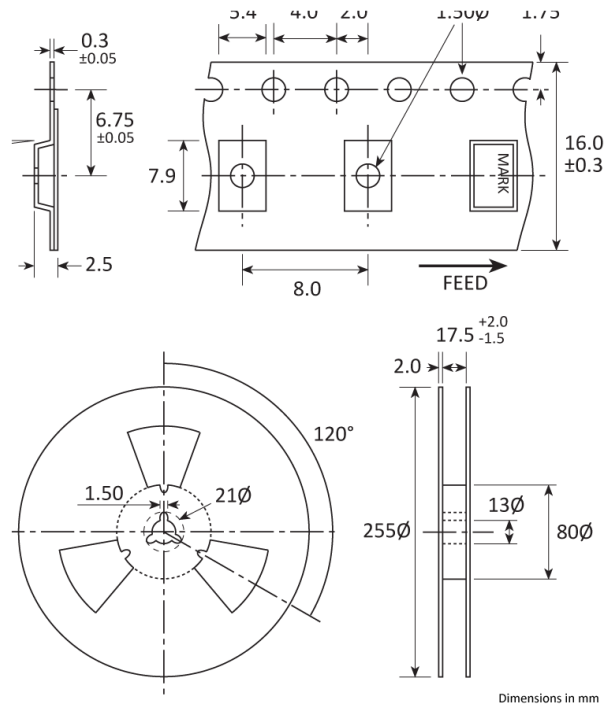

## HANDLING & STORAGE



Human Body Model (HBM) 1A (250V to &lt; 500V)



Moisture Sensitivity Level (MSL): 1

## COMPLIANCE



Lead-free (&lt; 0.1% by weight)



RoHS compliant with no exemptions.

## CONSTRUCTION

PCB carrier Metal screening lid