

SAW Filter 656.0MHz
Part No: MP01566

Model: TA0818A
Rev. No: 1

A. MAXIMUM RATING:

1. Input Power Level: 10 dBm
2. DC voltage: 5 V
3. Operating Temperature: -40°C to +85°C
4. Storage Temperature: -40°C to +85°C

B. ELECTRICAL CHARACTERISTICS:

Item	Unit	Min.	Typ.	Max.
Center frequency Fc	(dB)	-	656	-
Insertion loss at Fc IL	(dB)	-	2.3	3.5
3dB bandwidth	MHz	-	11	-
Ripple (654.5 ~ 657.5MHz)	(dB)	-	0.15	1.0
Attenuation (Reference level from 0dB)				
10 ~ 638MHz	(dB)	40	43.9	-
666 ~ 676MHz	(dB)	8	30.1	-
676 ~ 700MHz	(dB)	40	48.8	-
Temperature Coefficient	ppm/°C	-	-36	-
Source impedance Z _S	Ω	-	50	-
Load impedance Z _L	Ω	-	50	-

SAW Filter 656.0MHz
Part No: MP01566

Model: TA0818A
Rev. No: 1

C. MEASUREMENT CIRCUIT:

50Ω Test circuit (single-ended / single-ended)

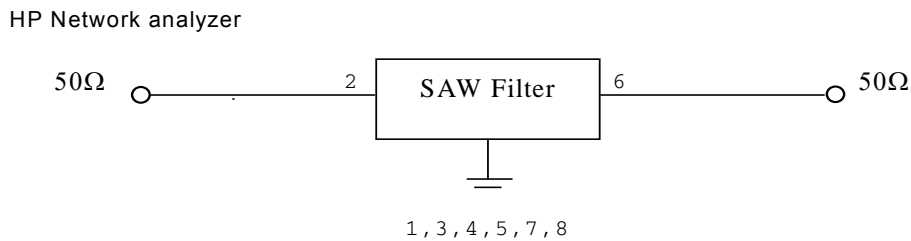

D. OUTLINE DRAWING:

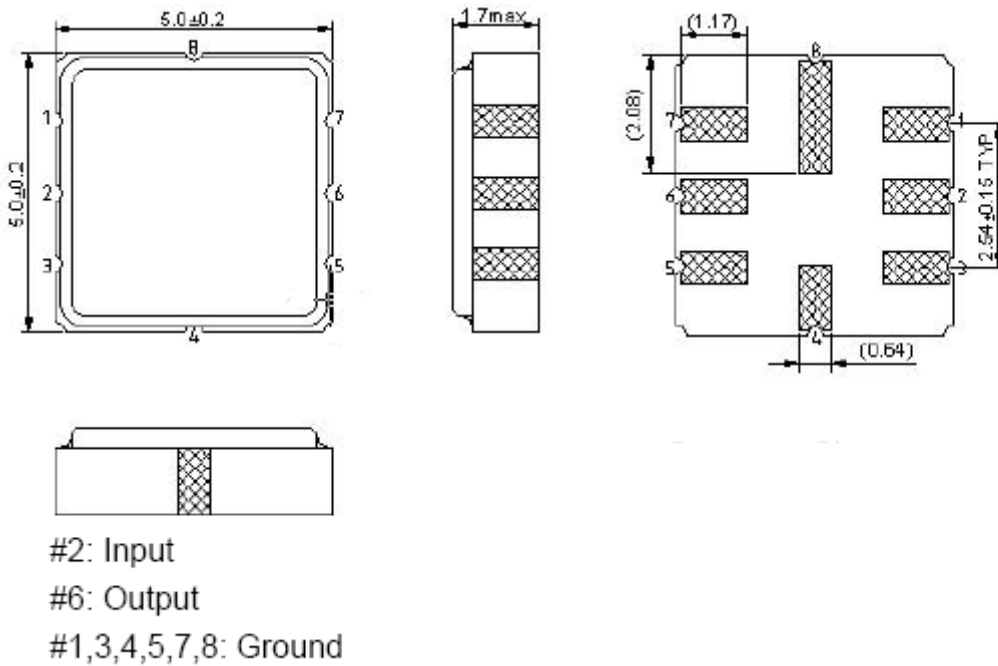

E. PCB FOOTPRINT:

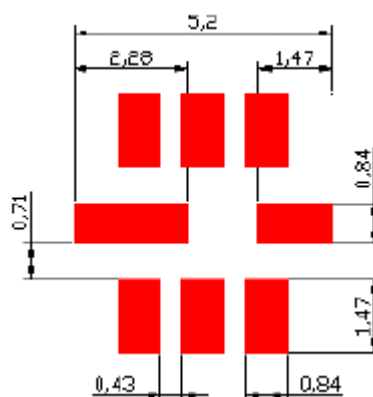

SAW Filter 656.0MHz
Part No: MP01566

Model: TA0818A
Rev. No: 1

F. FREQUENCY CHARACTERISTICS:

Transfer function

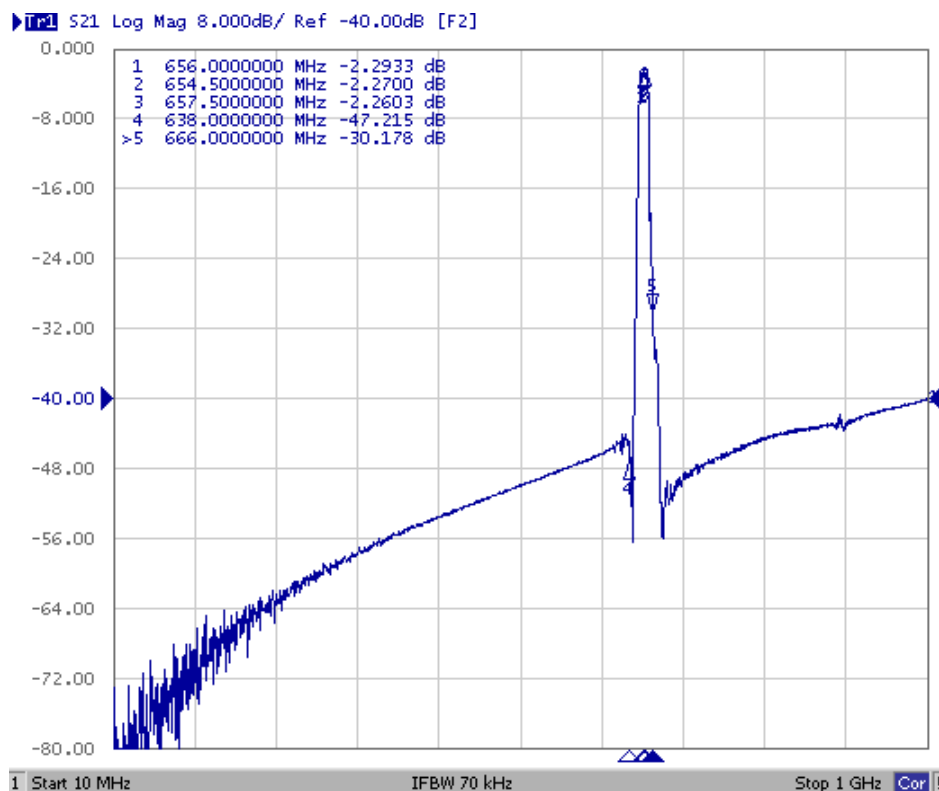
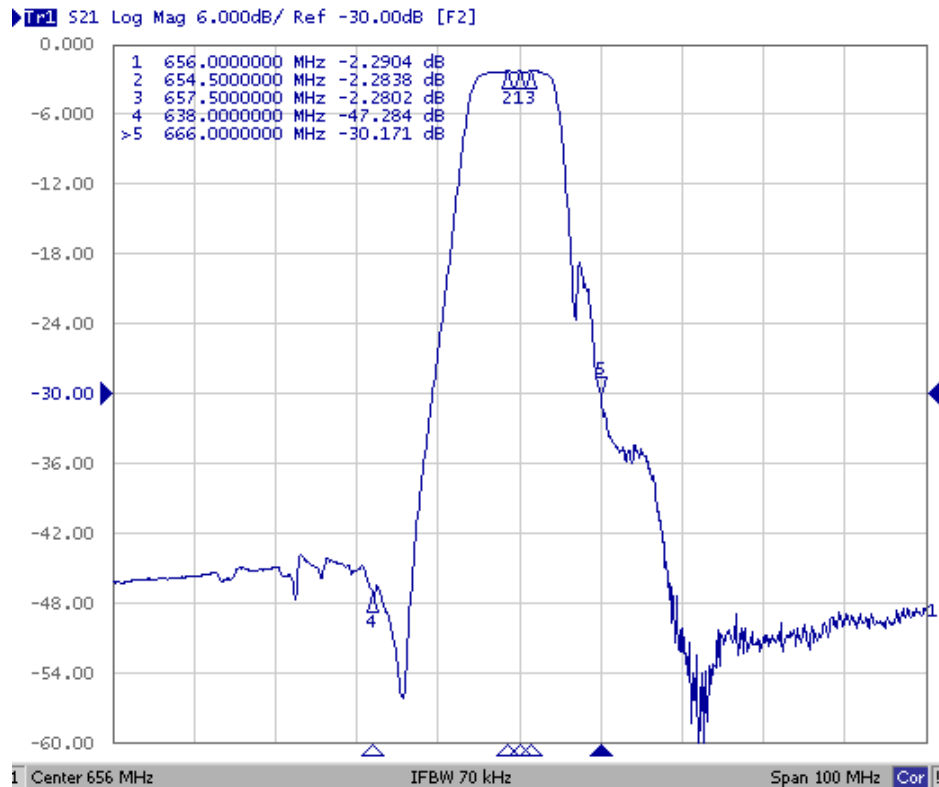

SAW Filter 656.0MHz
Part No: MP01566

Model: TA0818A
Rev. No: 1

G. PACKING:

1. Reel Dimension

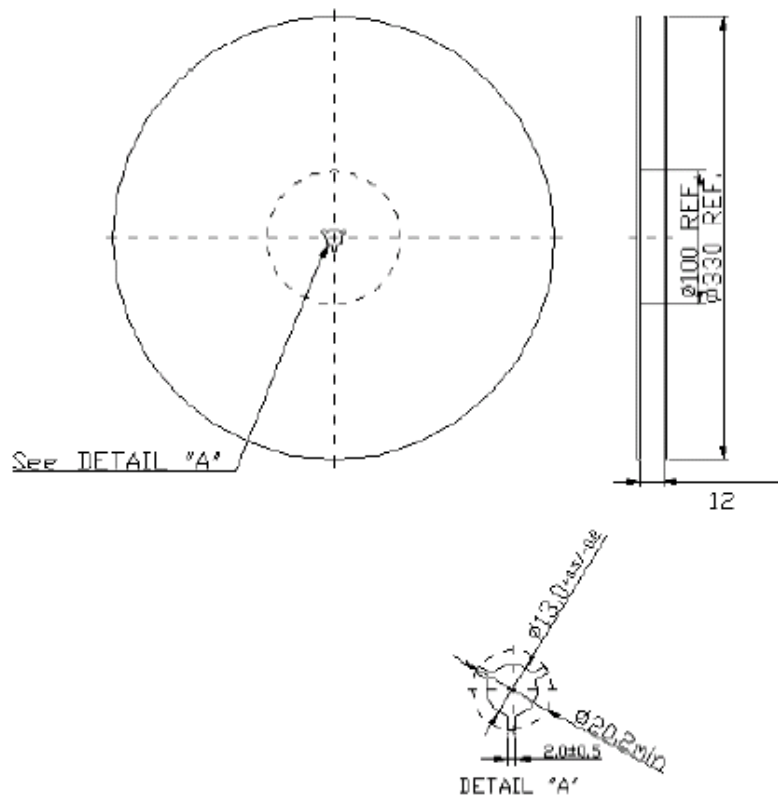

2. Tape Dimension

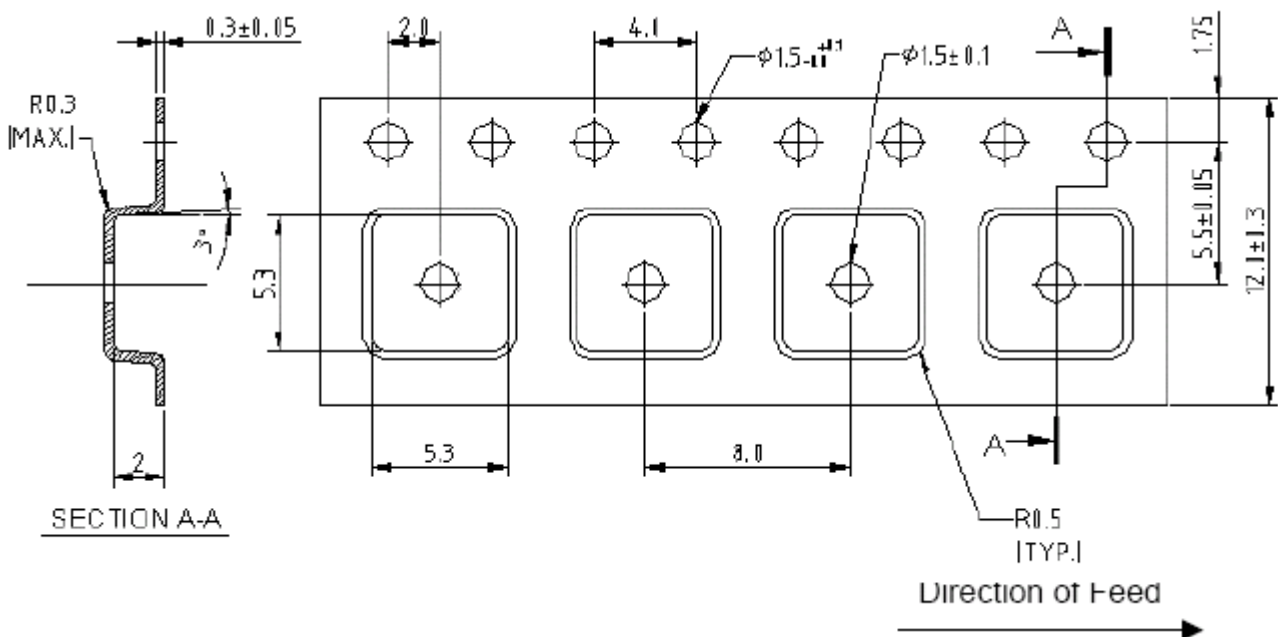

SAW Filter 656.0MHz
Part No: MP01566

Model: TA0818A
Rev. No: 1

H. RECOMMENDED REFLOW PROFILE:

