

**SAW Filter 283.50MHz**

**Model: TB0613A**

**Part No: MP01484**

**REV NO.: 1**

**A. MAXIMUM RATING:**

1. Input Power Level: 10 dBm
2. DC voltage: 5 V
3. Operating Temperature: : -20°C to +60°C
4. Storage Temperature: -40°C to +85°C

**B. ELECTRICAL CHARACTERISTICS:**

| Item                                    | Unit | Min. | Typ.  | Max. |
|---|------|------|-------|------|
| Center frequency Fc                     | MHz  | -    | 283.5 | -    |
| Minimum Insertion Loss, (Fc±50KHz ) IL  | dB   | -    | 4.2   | 6.5  |
| Passband Ripple (Fc±50KHz )             | dB   | -    | 0.6   | 2.0  |
| Group delay ripple (Fc±50KHz ), GD      | µs   | -    | 0.9   | 3.0  |
| Attenuation (Reference level from 0 dB) |      |      |       |      |
| Fc – 25 to Fc – 1.6 MHz                 | dB   | 50   | 65.0  | -    |
| Fc – 1.6 to Fc – 0.6 MHz                | dB   | 28   | 64.7  | -    |
| Fc + 0.6 to Fc + 1.6 MHz                | dB   | 28   | 63.7  | -    |
| Fc + 1.6 to Fc + 25 MHz                 | dB   | 50   | 63.0  | -    |

**C. MEASUREMENT CIRCUIT:**

**50 Ohm Test circuit (single-ended / single-ended)**

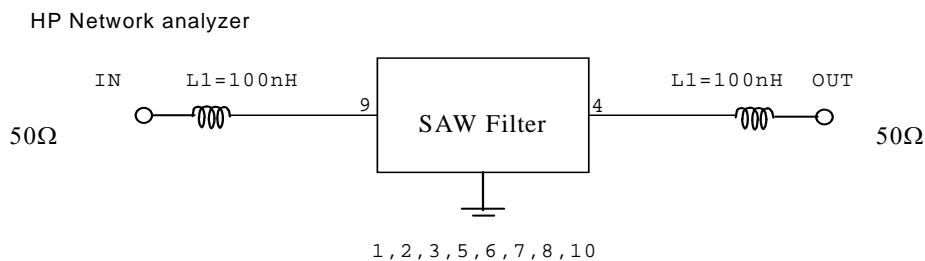

**SAW Filter 283.50MHz**

**Model: TB0613A**

**Part No: MP01484**

**REV NO.: 1**

**D. OUTLINE DRAWING:**

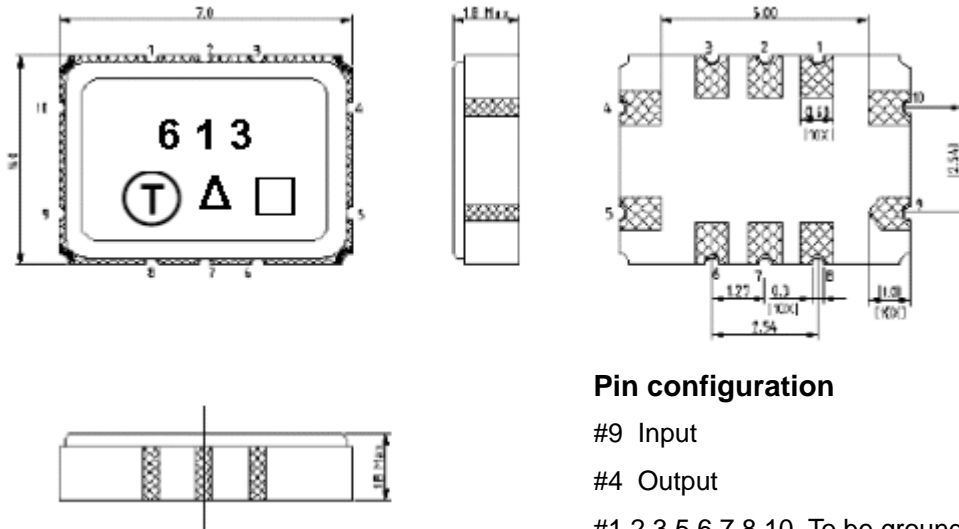

**Pin configuration**

- #9 Input
  - #4 Output
  - #1,2,3,5,6,7,8,10 To be grounded
- Unit mm

**E. PCB FOOTPRINT:**

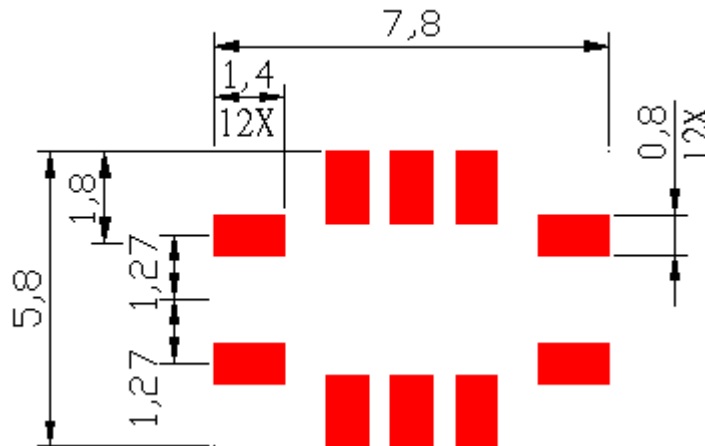

**SAW Filter 283.50MHz**  
**Part No: MP01484**

**Model: TB0613A**  
**REV NO.: 1**

**F. FREQUENCY CHARACTERISTICS:**

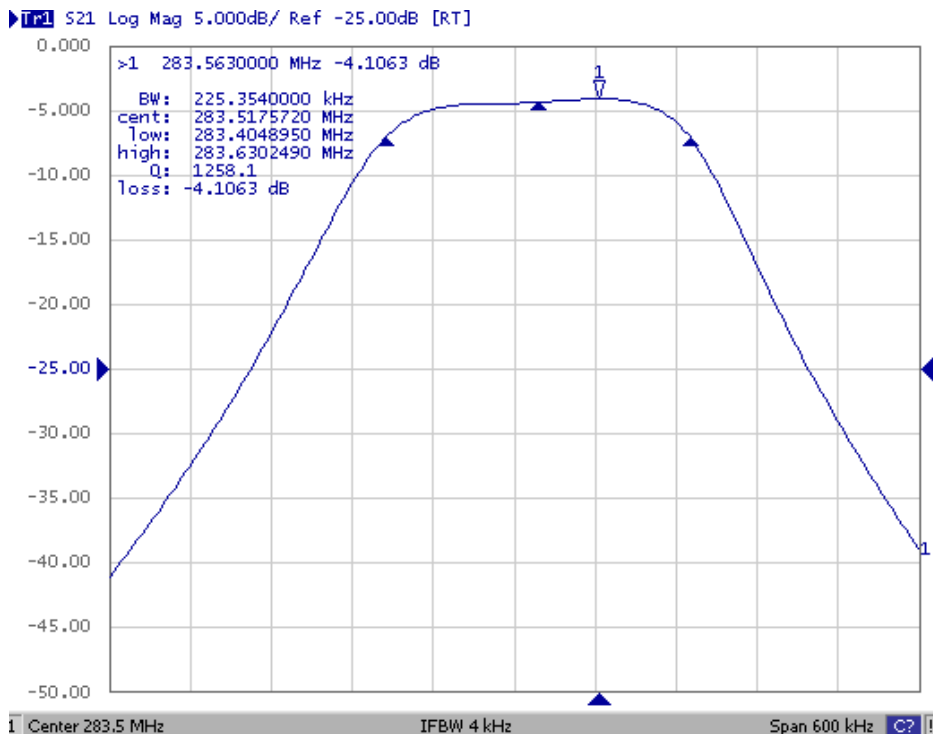
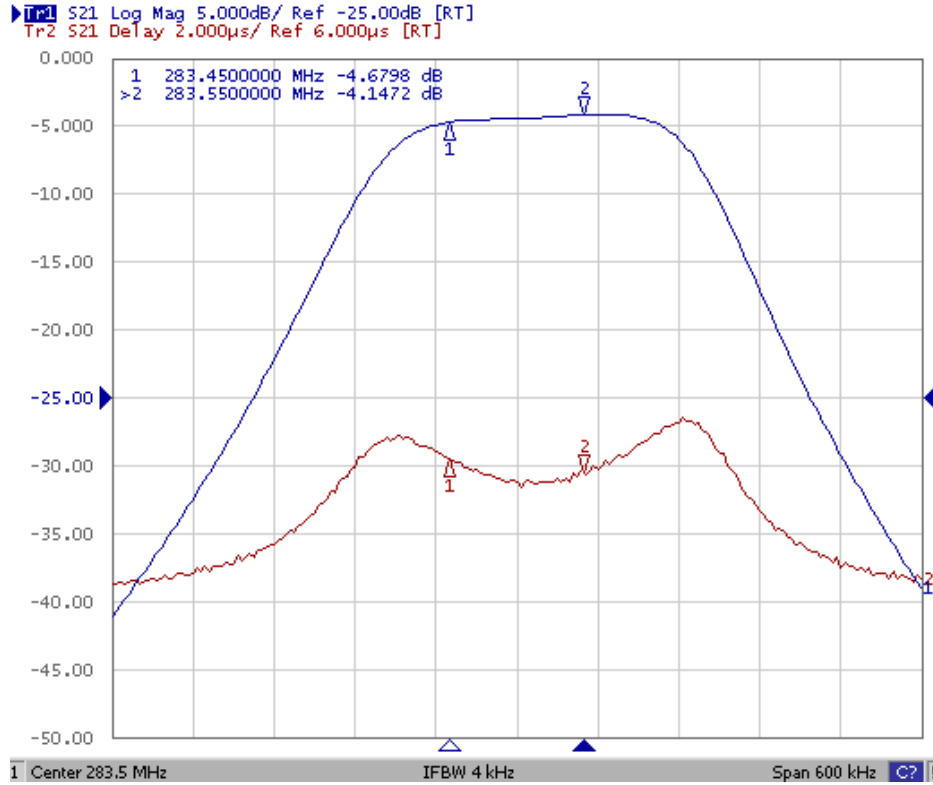

**SAW Filter 283.50MHz**  
Part No: **MP01484**

Model: **TB0613A**  
REV NO.: 1

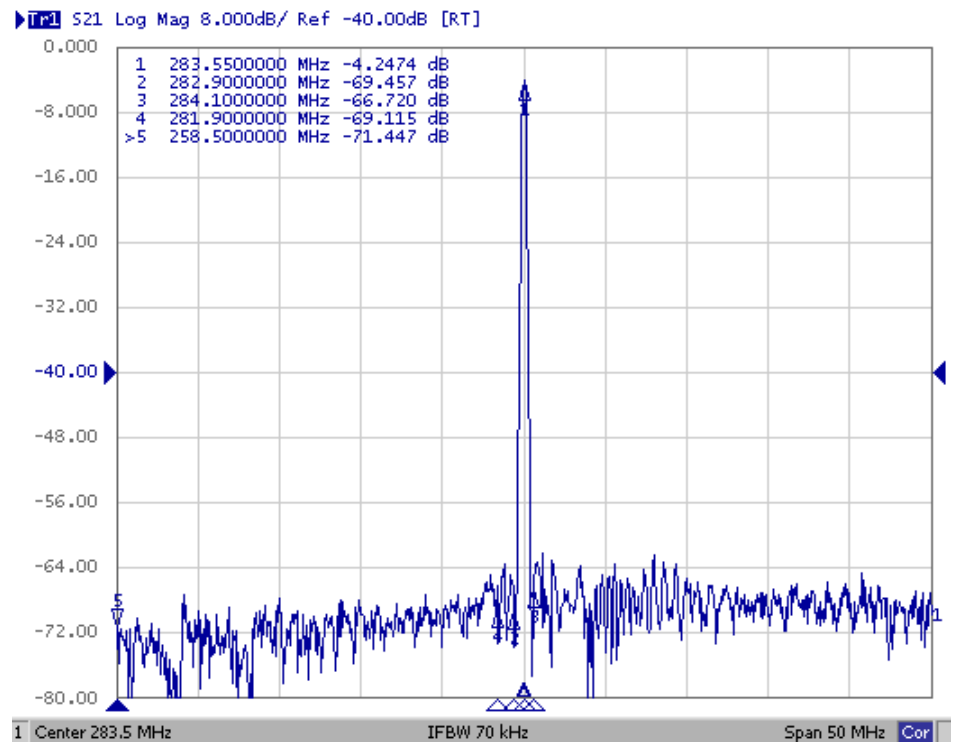
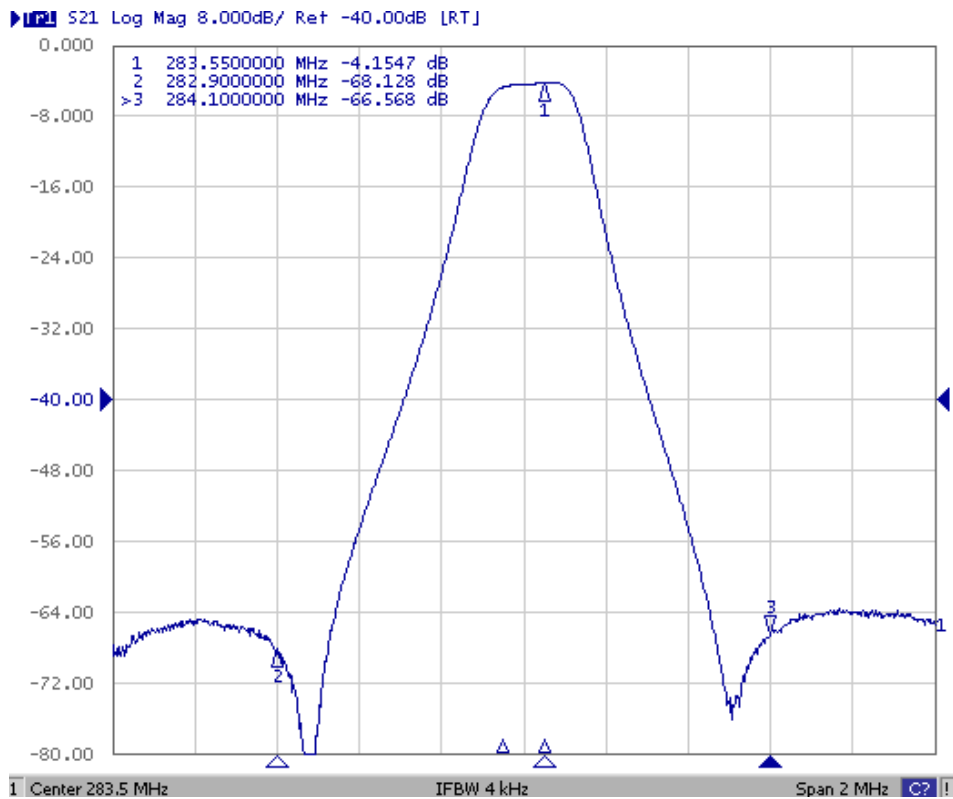

**SAW Filter 283.50MHz**

**Model: TB0613A**

**Part No: MP01484**

**REV NO.: 1**

**G. PACKING:**

**1. REEL DIMENSION**

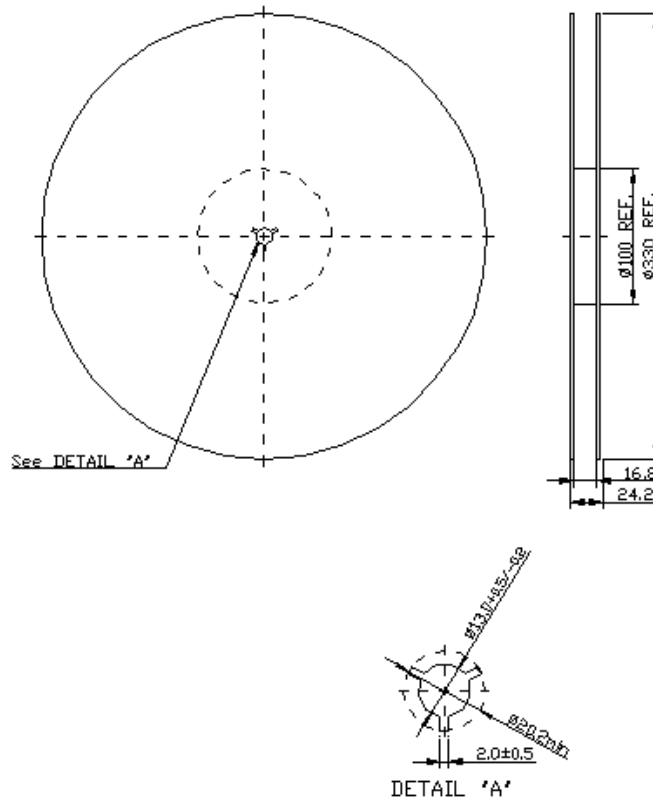

**2. TAPE DIMENSION**

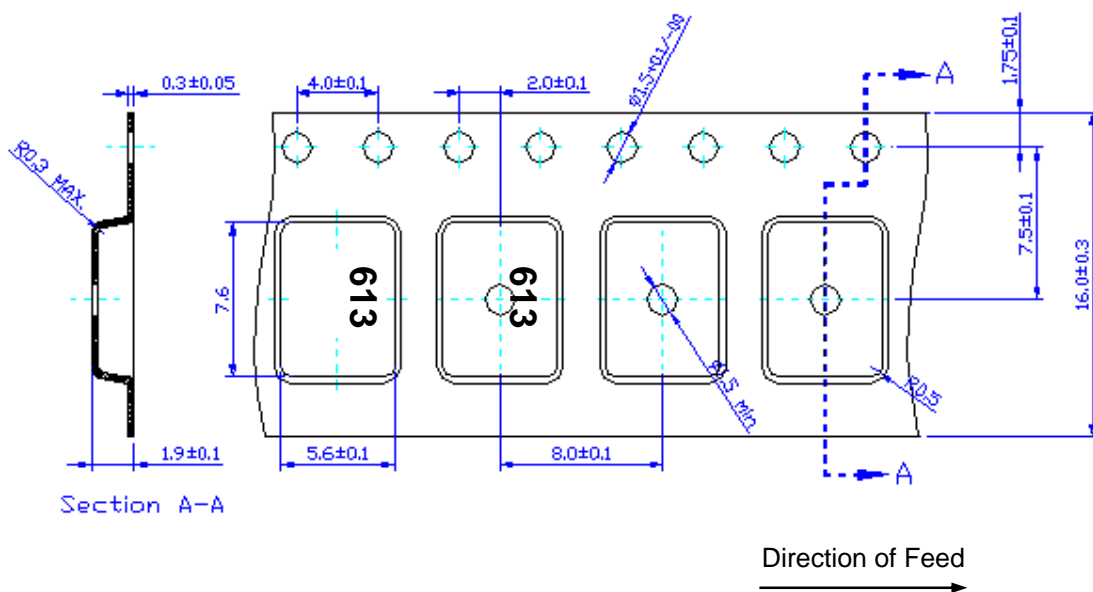

**SAW Filter 283.50MHz**

**Model: TB0613A**

**Part No: MP01484**

**REV NO.: 1**

**H. RECOMMENDED REFLOW PROFILE:**

