

SAW Filter 1575.42MHz
Part No: MP01175

Model: TA0769A
Rev No: 1

A. MAXIMUM RATING:

1. Input Power Level: 10dBm
2. DC Voltage: 3V
3. Operating Temperature: -40°C to +85°C
4. Storage Temperature: -55°C to +95°C

B. ELECTRICAL CHARACTERISTICS:

Terminating source impedance $Z_S = 50\Omega$

Terminating load impedance $Z_L = 50\Omega$

Item	Unit	Min.	Typ.	Max.	Note
Center Frequency Fc	MHz	-	1575.42	-	-
Max. Insertion Loss (1574.42 ~ 1576.42MHz) IL	dB	-	1.15	1.6	-
Amplitude ripple (1574.42 ~ 1576.42MHz)	dB	-	0.1	0.5	-
VSWR (1574.42 ~ 1576.42MHz)		-	1.2	1.9	-
Attenuation					
100 ~ 960MHz	dB	31	33	-	-
960 ~ 1460MHz	dB	31	33	-	-
1460 ~ 1513MHz	dB	22	26	-	-
1648 ~ 1710MHz	dB	22	28	-	-
1710 ~ 1990MHz	dB	25	32	-	-
1990 ~ 2300MHz	dB	25	30	-	-
2300 ~ 4000MHz	dB	29	31	-	-
4000 ~ 6000MHz	dB	20	24	-	-

SAW Filter 1575.42MHz
Part No: MP01175

Model: TA0769A
Rev No: 1

C. OUTLINE DRAWING:

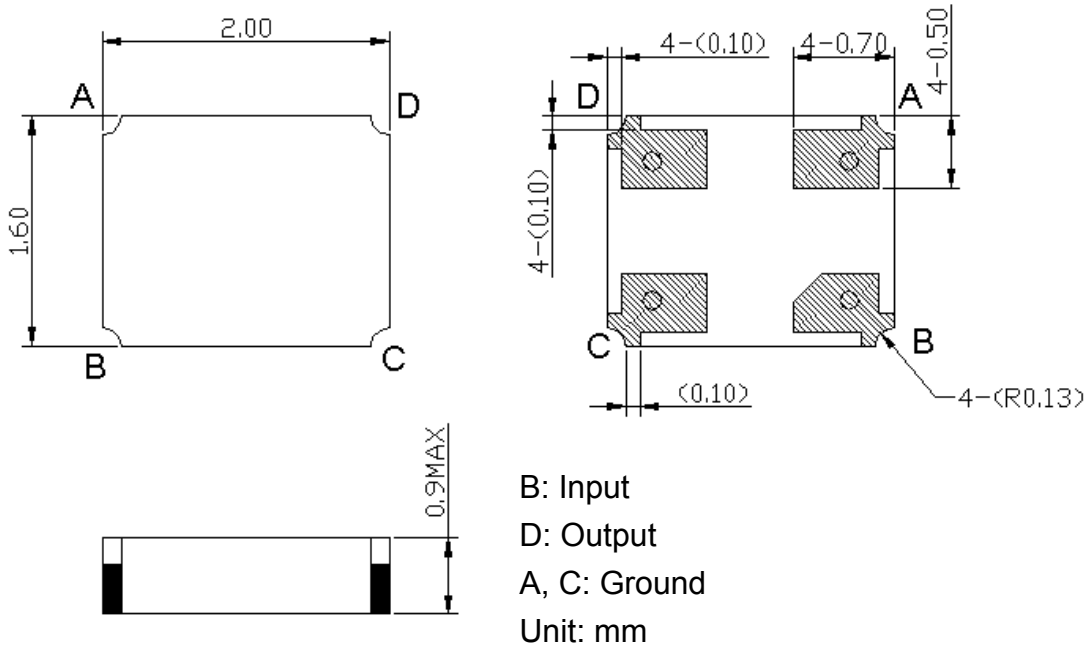

D. MEASUREMENT CIRCUIT:

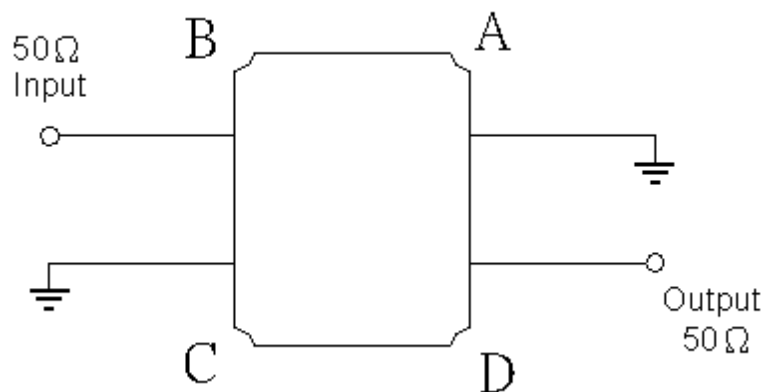

SAW Filter 1575.42MHz
Part No: MP01175

Model: TA0769A
Rev No: 1

E. FREQUENCY CHARACTERISTICS:

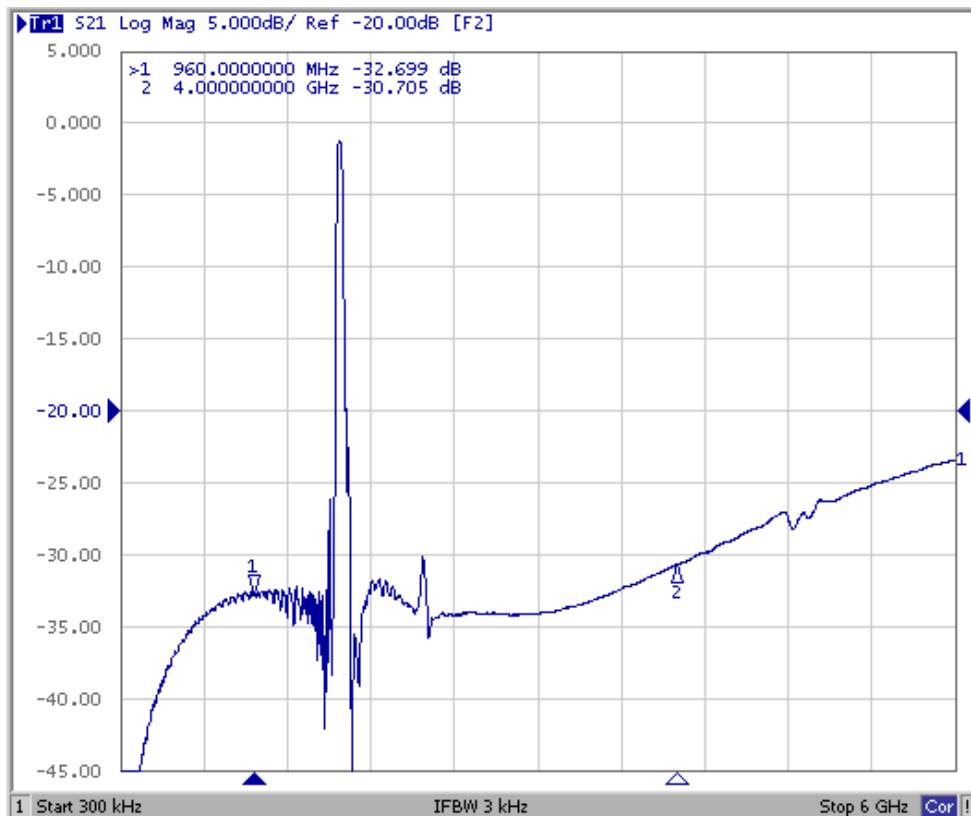
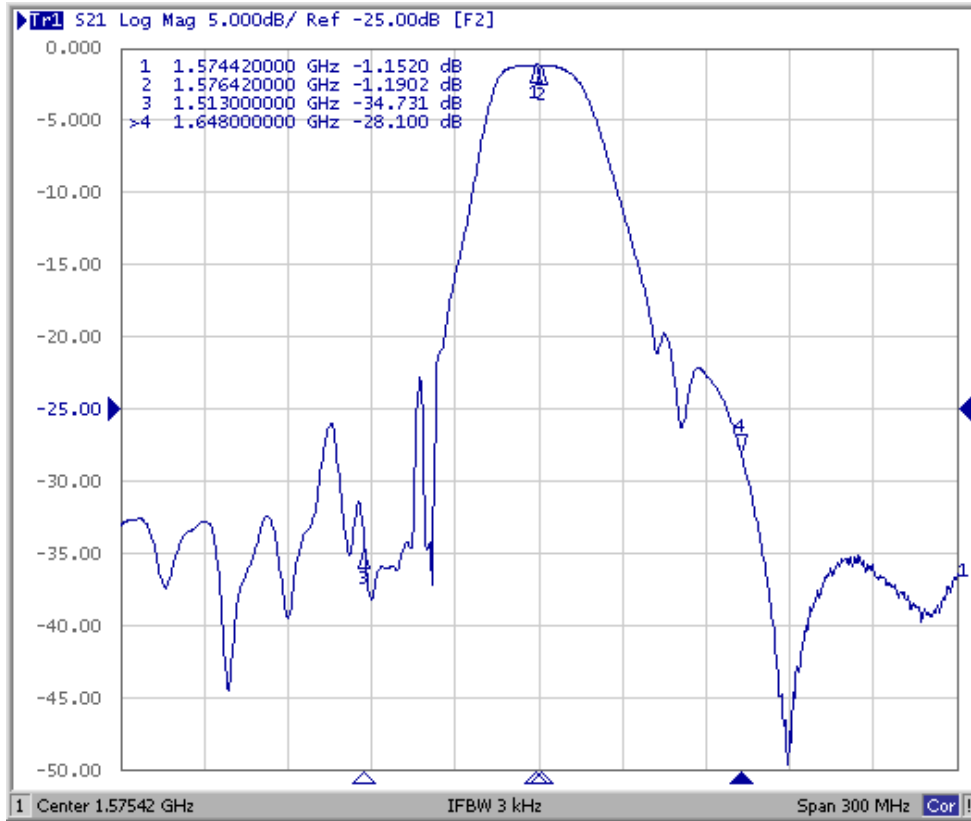

SAW Filter 1575.42MHz
Part No: MP01175

Model: TA0769A
Rev No: 1

Reflection Functions

S11

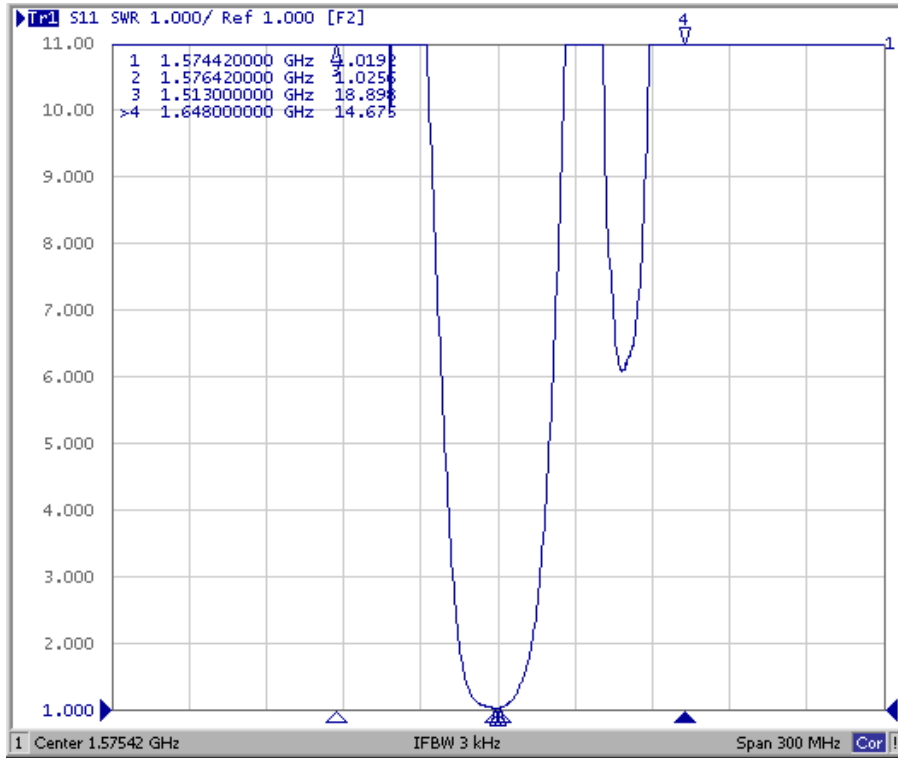

S22

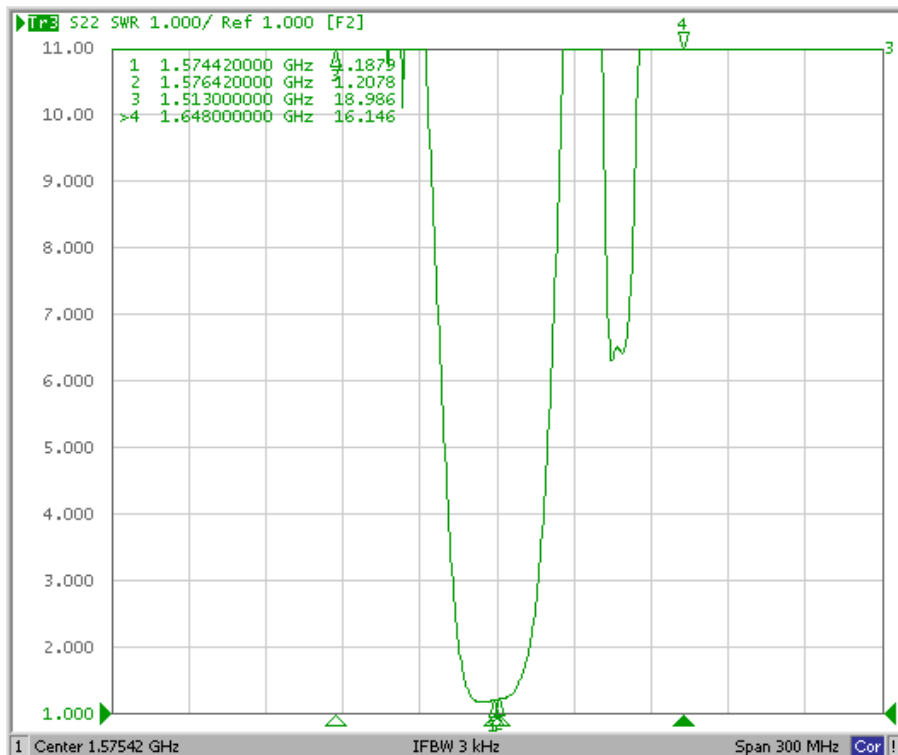

SAW Filter 1575.42MHz
Part No: MP01175

Model: TA0769A
Rev No: 1

F. PACKING:

1. Reel Dimension (Reel Count: 7" = 2000 typ.; 13" = 10000 typ.)

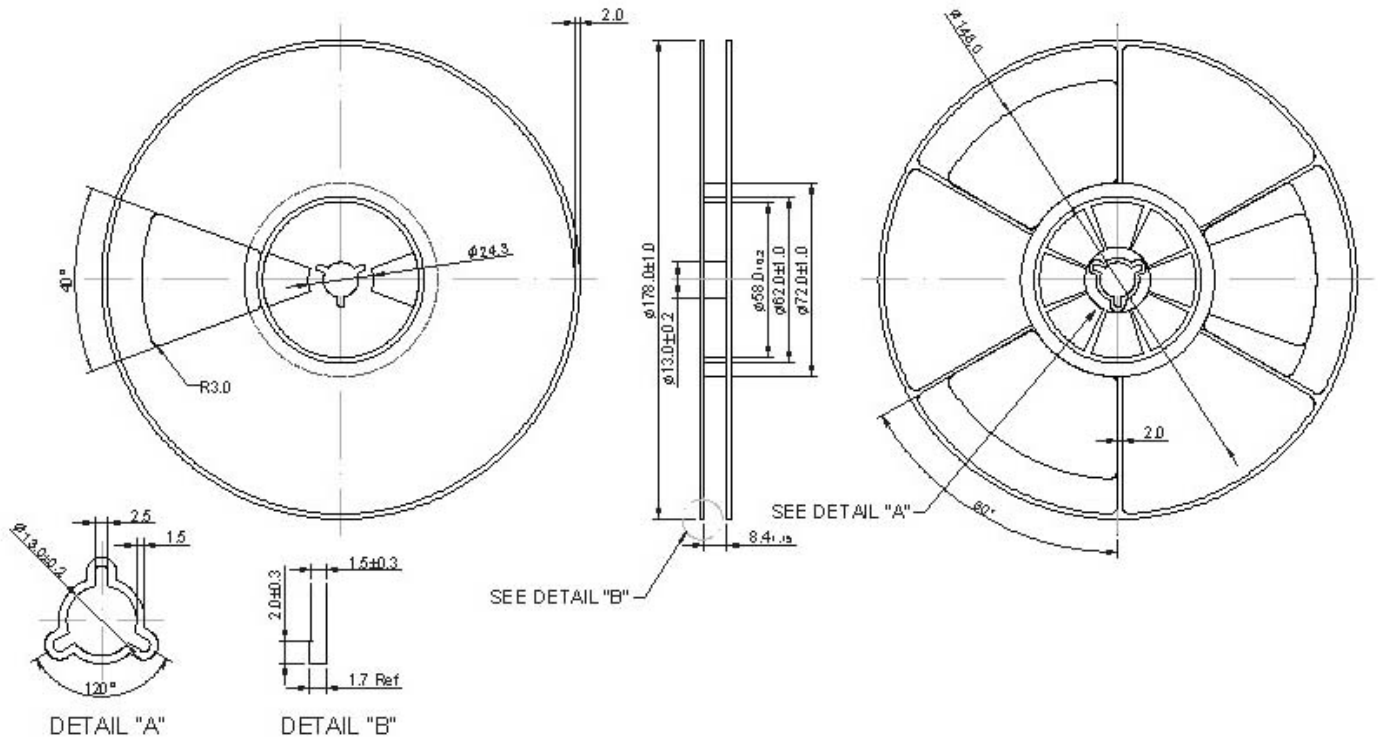

2. Tape Dimension

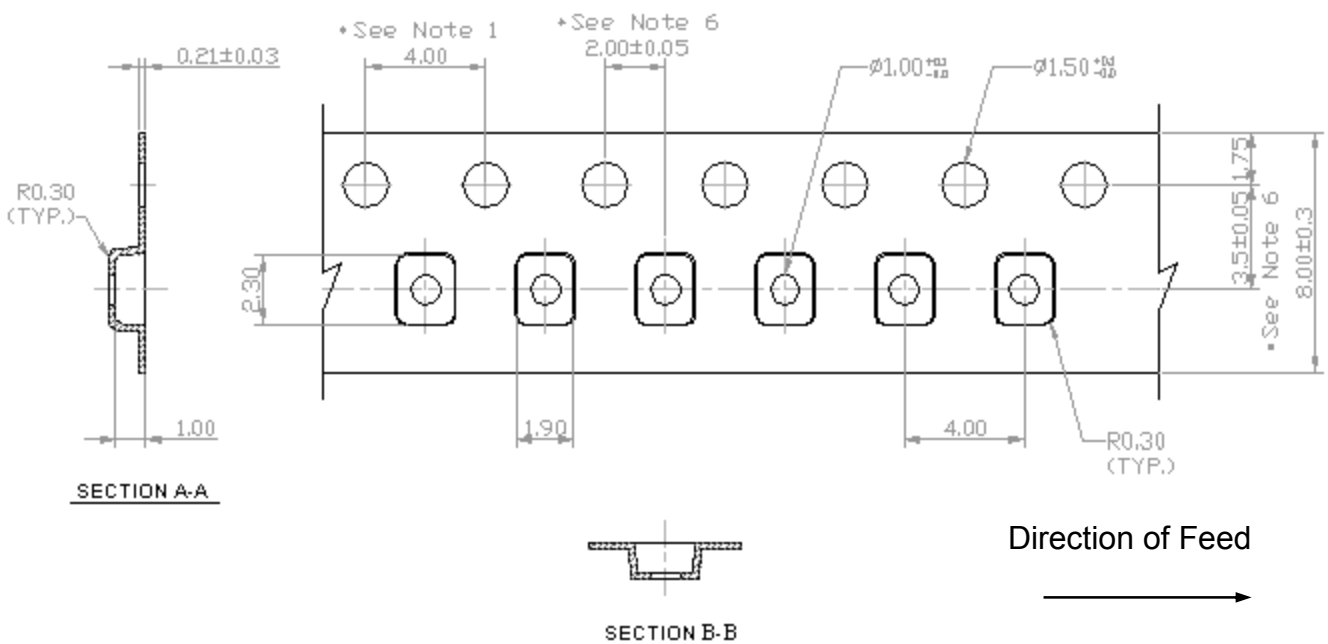

SAW Filter 1575.42MHz
Part No: MP01175

Model: TA0769A
Rev No: 1

G. RECOMMENDED REFLOW PROFILE:

