

SAW Filter 402.70MHz

Model: TB0237A

Part No: **MA06656**

REV. NO.: 1

A. MAXIMUM RATING:

1. Input Power Level: 10 dBm
2. Operating Temperature: -40°C to 85°C
3. Storage Temperature: -40°C to 85°C

B. ELECTRICAL CHARACTERISTICS:

Item	Unit	Min.	Type.	Max.	Note
Center frequency, Fc	MHz	-	402.7	-	
Minimum Insertion Loss, IL	dB	-	13.7	19	
Amplitude Ripple in Fc±9.5MHz,AR	MHz	-	0.8	1.2	
Group delay ripple in Fc±9.5MHz	ns	-	50	100	
2dB Bandwidth	MHz	21.5	23		
30dB Bandwidth	MHz	-	32		
Relative attenuation (relative to min. IL)			-		
375 MHz ~ Fc-17.5MHz	dB	28	36	-	
Fc+17.5MHz ~ 430MHz	dB	29	34	-	
Temperature coefficient of frequency	ppm/°C		-18	-	

C. MEASUREMENT CIRCUIT:

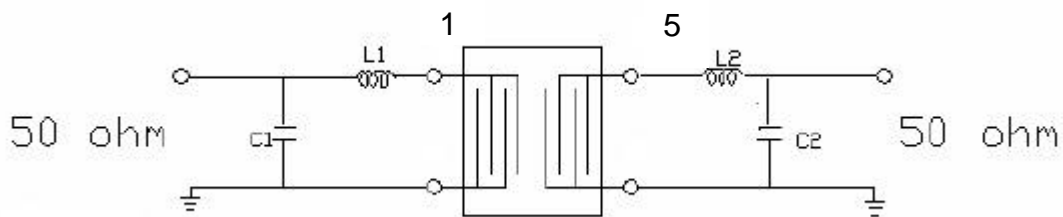

**Input L1=18nH, C1=18pF
 Output L2=18nH, C2=18pF**

SAW Filter 402.70MHz

Model: TB0237A

Part No: MA06656

REV. NO.: 1

D. FREQUENCY CHARACTERISTICS:

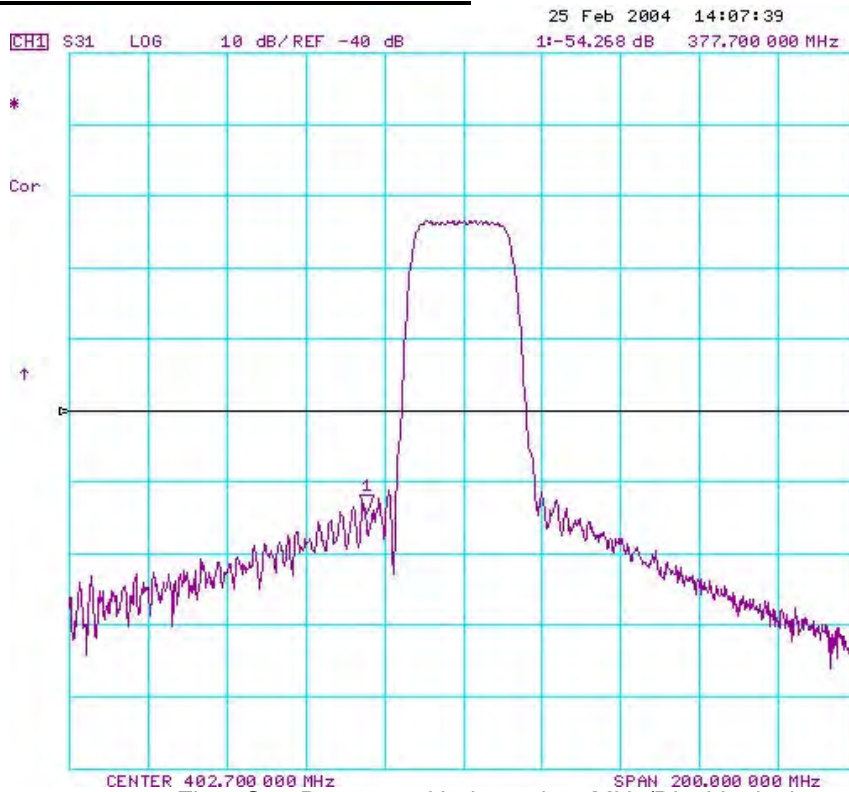

Fig-1 S21 Response Horizontal: 20MHz/Div. Vertical: 10dB/Div

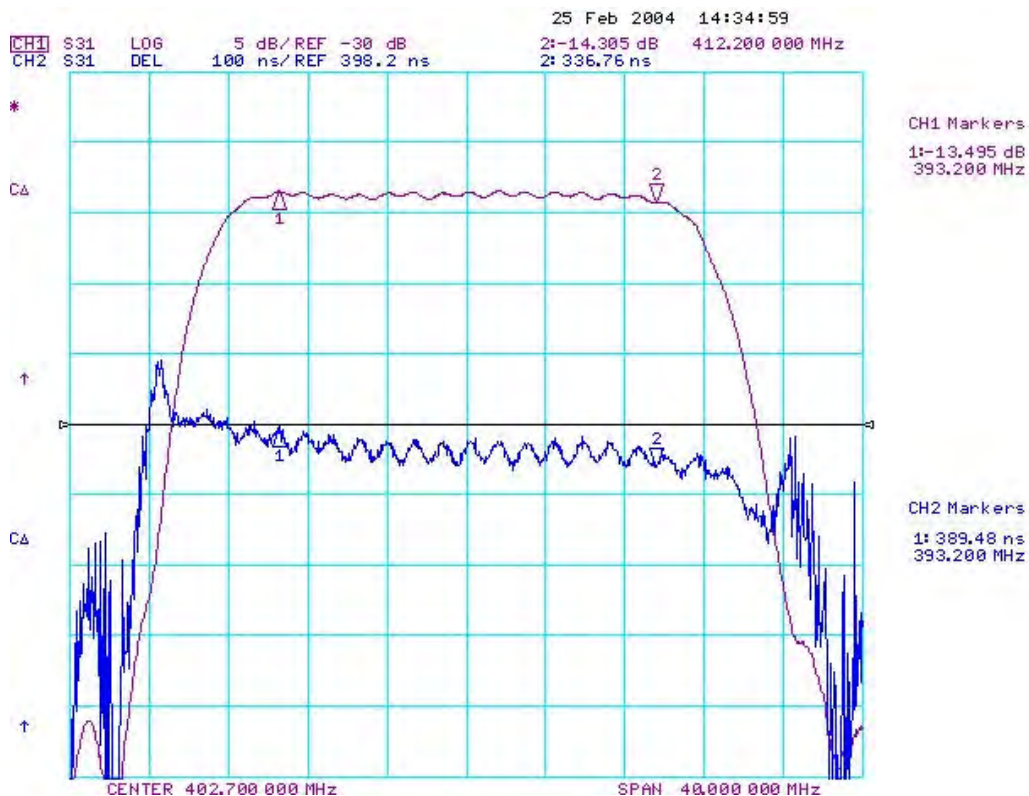

Fig-2 Horizontal: 400KHz/Div Vertical: 5dB/Div. Vertical: 100ns/Div

SAW Filter 402.70MHz

Model: TB0237A

Part No: MA06656

REV. NO.: 1

E. OUTLINE DRAWING:

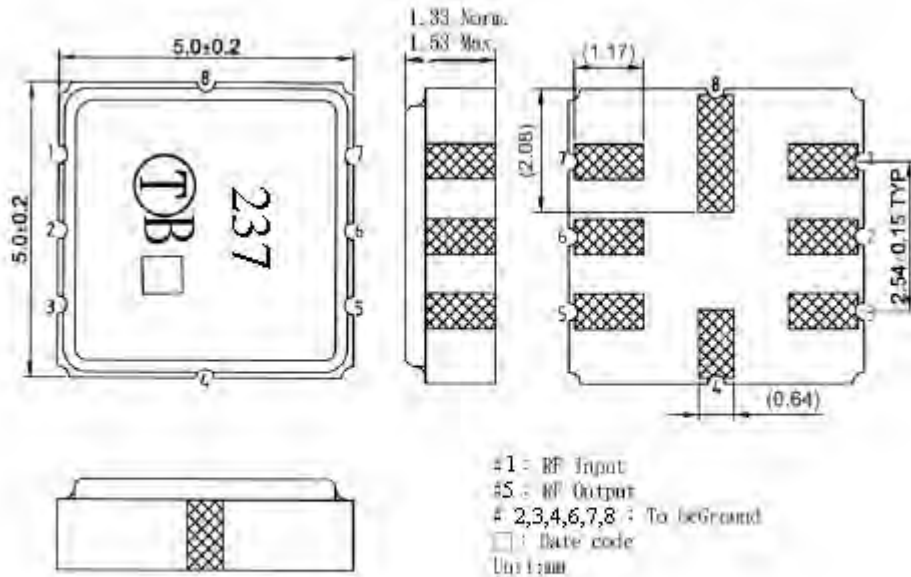

F. PCB FOOTPRINT

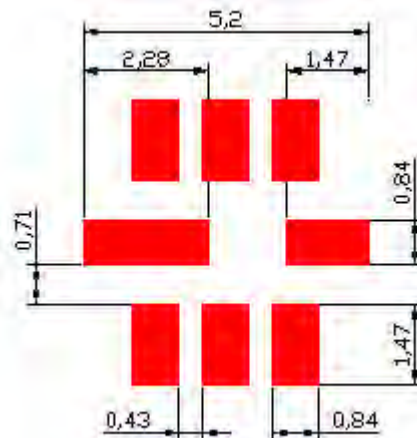

SAW Filter 402.70MHz

Model: TB0237A

Part No: MA06656

REV. NO.: 1

G. PACKING:

1. REEL DIMENSION

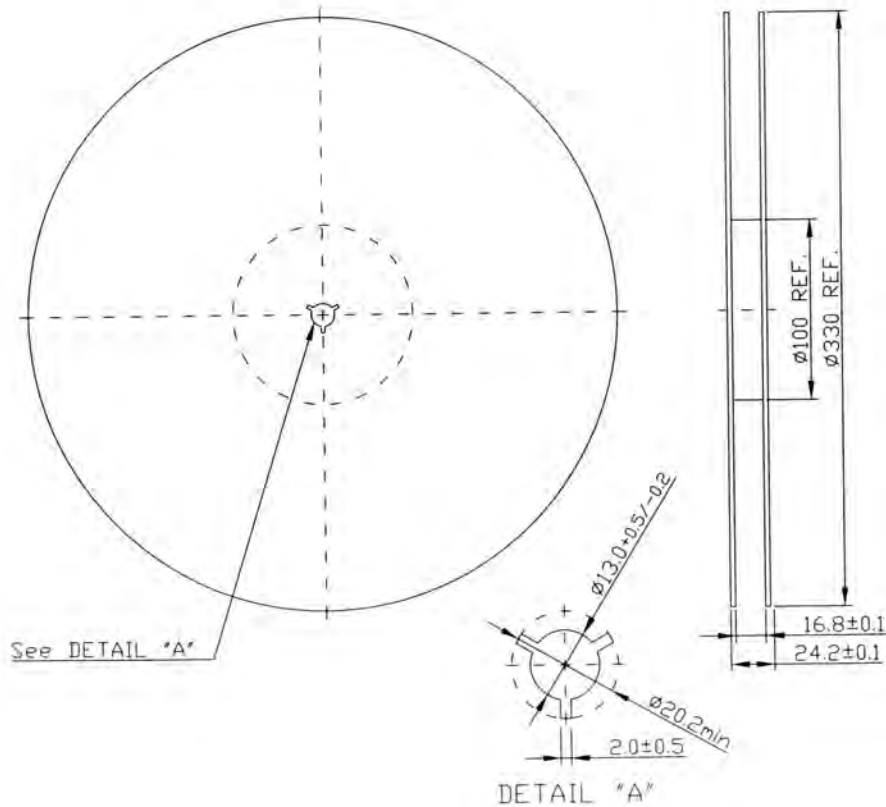

2. TAPE DIMENSION

